

33 Middle Road, Park Gate, Southampton, Hampshire, SO31 7GH
Tel: 01489 885500
admin@brookindependent.co.uk
www.brookindependent.co.uk

BROOK
INDEPENDENT
ESTATE AGENTS



61 Osborne Road

, Warsash, SO31 9GJ

£399,950



Welcome to this charming end terrace house located on Osborne Road in the picturesque village of Warsash.

This delightful property boasts a spacious kitchen family room extension, perfect for hosting gatherings with friends and family. The ground floor bathroom features an eco-friendly Aqualisa water system, ensuring both luxury and efficiency.

With 3 cosy bedrooms and generous living space, this home offers ample room for a growing family or those who love to entertain. The bi-fold doors seamlessly fuse the interior with the outdoors, creating a bright and airy atmosphere throughout.

One of the standout features of this property is the versatile multi-purpose garden room, currently set up as a gym. Whether you're looking for a home office, a playroom for the kids, or a tranquil space to unwind, this garden room offers endless possibilities.



Entrance Porchway

Living Room 16'4 x 15'8 (4.98m x 4.78m)

Open Plan Kitchen/Family Room 19'2 x 16'1 (5.84m x 4.90m)

Ground Floor Bathroom 10'11 x 4'6 (3.33m x 1.37m)

Utility Room

Bedroom One 13'11 x 12'3 (4.24m x 3.73m)

Bedroom Two 12'9 x 8'7 (3.89m x 2.62m)

Bedroom Three 9'4 x 6'8 (2.84m x 2.03m)

First Floor Cloakroom

Area Map



Floor Plans

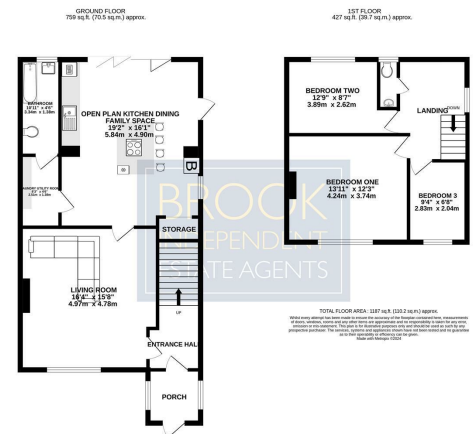

Energy Efficiency Graph

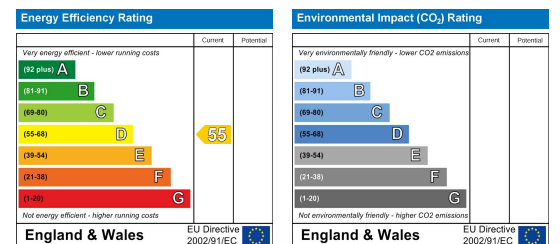

These particulars, whilst believed to be accurate are set out as a general outline only for guidance and do not constitute any part of an offer or contract. Intending purchasers should not rely on them as statements of representation of fact, but must satisfy themselves by inspection or otherwise as to their accuracy. No person in this firm's employment has the authority to make or give any representation or warranty in respect of the property.