

33 Middle Road, Park Gate, Southampton, Hampshire, SO31 7GH

Tel: 01489 885500

admin@brookindependent.co.uk

www.brookindependent.co.uk

BROOK
INDEPENDENT
ESTATE AGENTS



4 Holly Close

Sarisbury Green, Southampton, SO31 7BW

£225,000



A great opportunity to get on the property ladder is offered by this 1960's built ground floor maisonette set in an idyllic location on the edge of holly hill. It's benefits include two bedrooms, a living room with fireplace and a large rear garden, very unusually found in a property in this price range. The property has a traditional layout with the principle rooms approached from a spacious central hallway. There is plenty of parking to the front with space for three cars if required.

Holly Close is a cul de sac location just off Barnes Lane, a short stroll from Holly Hill Woodland park. There are a number of nearby local shops around the corner with more comprehensive facilities available at the Locks Heath District Centre which is under a mile drive. The M27 is approximately a two mile drive and there are good rail links at Swanwick Station to all the major south coast centres and London.

This value for money house is an ideal first purchase or a fine 'Buy to Let' investment for those looking for decent return with an approximate rent value of £850 p.c.m.

Council Tax Band: A
Fareham Borough Council



Entrance Hallway

Living Room With Fireplace 13'8 x 13'1 (4.17m x 3.99m)

Kitchen 11'4 x 7'4 (3.45m x 2.24m)

Bathroom

Bedroom One 11'6 x 9'11 (3.51m x 3.02m)

Bedroom Two 9'4 x 7'5 (2.84m x 2.26m)

Area Map



Floor Plans

GROUND FLOOR

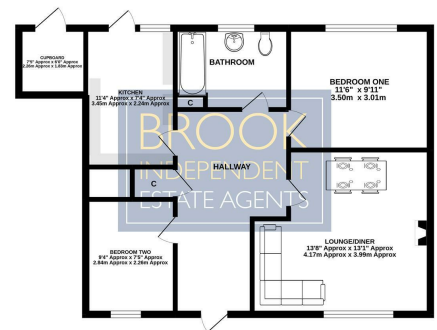

Energy Efficiency Graph

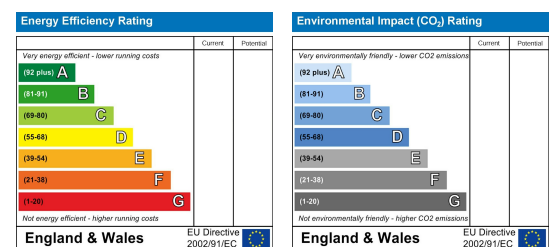

These particulars, whilst believed to be accurate are set out as a general outline only for guidance and do not constitute any part of an offer or contract. Intending purchasers should not rely on them as statements of representation of fact, but must satisfy themselves by inspection or otherwise as to their accuracy. No person in this firm's employment has the authority to make or give any representation or warranty in respect of the property.